

## Vacuum Solenoid Valve DN16 ISO-KF NO

(Also usable as power failure vent valve with ambient air)

### 2/2-Way Vacuum Vent Valve for High Vacuum Applications

#### Specification

2/2-Way Valve	Electromagnetic
Flange Size	DIN 28 403 / ISO 2861/1 / KF16
Nominal Width	DN 1,6
Pressure Range	0-1 bar absolute
Function	NO (normally open)
Materials	Al Si1MGMn 1.4105, 1.4303, 1.4310
Usage	for Air-, Gas- Vacuum
Media Temperature	-10°C to 120°C
Ambient Temp.	max. 50°C
Leak Rate int./ext.	<1*10 <sup>-9</sup> mbar l/sec
Endurance	min. 500 000 Cycles
Voltage Options	12V AC/DC to 230V AC/DC

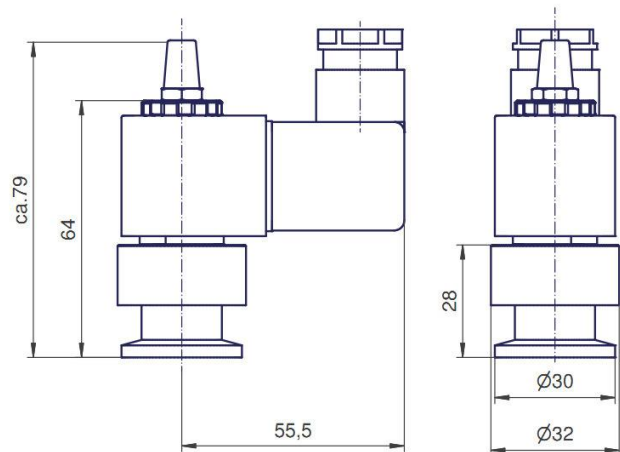

#### Order Information

Vacuum Vent Valve DN16 ISO-KF, NO (normally open)  
 Solenoid 12 V DC, 6.2 W incl. Connector  
 Solenoid 24 V DC, 6.8 W incl. Connector  
 Solenoid 230 V DC, 10.5 VA incl. Connector  
 Others voltages on request

Order No. 1006002722  
 Order No. 1006003523  
 Order No. 1006002747  
 Order No. 1006002656